

# Project information Nelskamp Planum PV

## Roof tile works Nelskamp

E-Mail: [solar@nelskamp.de](mailto:solar@nelskamp.de)

**Project:**

**Wholesaler:**

<b>Contact person:</b>	
Client:	Architect/ site management:
Street:	Street:
City:	City:
Tel.:	Tel.:
Mobile:	Mobile:
Fax:	Fax:
E-Mail:	E-Mail:
Roofer:	Electrician:
Street:	Street:
City:	City:
Tel.:	Tel.:
Mobile:	Mobile:
Fax:	Fax:
E-Mail:	E-Mail:
<b>Location of planned PV system</b>	(if not identical with the clients' address)
Street:	House number:
Zip code:	City:

<b>Roof information</b>		
Roof shape	Gable roof <input type="checkbox"/>	Pent roof <input type="checkbox"/>
Tent roof	Hipped roof <input type="checkbox"/>	Half-hipped roof <input type="checkbox"/>

**Roof orientation**

Mark orientation

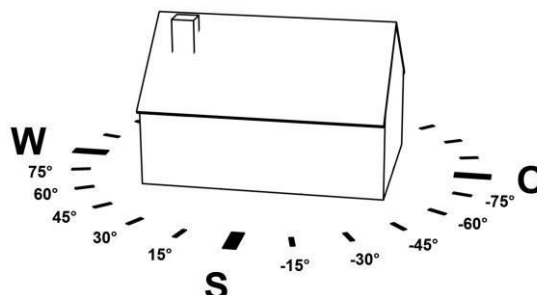

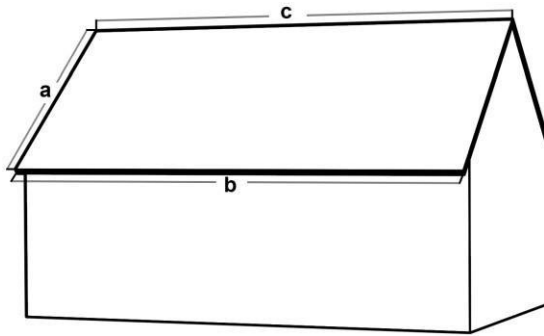

### Roof measures

Rafter length (incl. roof overhang)	a	m		
Eaves length (incl. roof overhang)	b	m		
Ridge length	c	m		
Roof inclination (degrees)				
Roof covering <b>Planum</b>	<input type="checkbox"/>	yes	<input type="checkbox"/>	no
Roof covering <b>Planum PV</b> Cover length	from	32,5 cm	to	34,0 cm
			Counter batten	cm
			Roof batten	cm
<b>Information on the existing / planned roof</b>				
Distance of the PV System to the inverter (one way cable length)			m	
Dormers/windows/vents/ Antennae...	<b>Mark in the roof drawing!</b>		<b>Photos!</b>	
Building type	New built	<input type="checkbox"/>	Detached house	<input type="checkbox"/>
	Project phase	<input type="checkbox"/>	Renovation	<input type="checkbox"/>
	Semi-detached house	<input type="checkbox"/>	Multi-family house	<input type="checkbox"/>
	Terraced house	<input type="checkbox"/>	Hall	<input type="checkbox"/>
Private	<input type="checkbox"/>		Agricultural building	
Commercial	<input type="checkbox"/>			
Shading	no	<input type="checkbox"/>	Shading	yes <input type="checkbox"/>
			How many hours a day?	
Shading through	Buildings	<input type="checkbox"/>	Trees	<input type="checkbox"/>
	Chimneys	<input type="checkbox"/>	Antennae	<input type="checkbox"/>
<b>Please include planning aids!</b>	Site plan	<input type="checkbox"/>	<b>Drawings</b>	<input type="checkbox"/>
	<b>Photos!</b>	<input type="checkbox"/>	Roof plan	<input type="checkbox"/>

<b>Information PV System</b>			
Electricity consumption per year			kWh
Favoured system power			kWp
Electric car charging station wanted	yes	no	
Battery system wanted	yes	no	
Favoured battery capacity			kWh
Snow guard wanted	yes	no	
<b>Information electrician</b>			
Electrician at hand	yes	no	
Electrician recommendation wanted	yes	no	

**Other information**

**Signatures**

With the signing of the project information form the essential details on the desired PV system have been documented.

The information are not binding and may be subject to change during implementation planning.

The two parties (client and company) agree that upcoming changes during planning or implementation must be communicated and documented.

**Without the filled project information form no reliable project report / planning and quotation can be generated!**

Location: \_\_\_\_\_

Date: \_\_\_\_\_

\_\_\_\_\_  
**Signature client**

\_\_\_\_\_  
**Signature company**

Stand 08.2022 FE